

Protect what matters most.

Description	PipeBurst Pro is a complete leak detection and flood prevention system. As a whole, the system detects leaks using both point detection and flow-based detection. Once a leak has been detected, the WaterValve will close the water line, stopping the water at the source to prevent damage.	
Detection	Wireless / Wired Water Sensors	Wireless & Wired sensors should be placed in likely places for leaks. These sensors will detect the physical presence of water. Once water has been detected, the sensor will alert the Gateway to close the WaterValve.
	FloMeter	The FloMeter detects the amount of water flowing through the water line by the gallon. It will send this information to the Gateway and using preset parameters for home and away settings will detect unusual water usage as another type of leak detection.
Gateway	The GT500 coordinates information between our graphical user interface, ionleaks.com and the hardware components of the PBP5 system.	
	Wireless Frequency	915MHZ
	Power Supply	12VDC
Actuated Valve	Upon the detection of a leak, PipeBurst Pro WaterValves close the water line immediately to stop water from flowing, resulting in minimal water damage.	
	Sizes	¾" – 4", Larger Special Order
	Power Supply	12VDC
Relay & Switch Device	The Relay & Switch Device communicates between two devices via dry contact outputs and inputs. This device allows for the communication of open/close signals to the Actuated Valve and the reception of water usage from the FloMeter.	
	Power Supply	5VDC
Ionleaks.com	Online interface for the entire system that allows for a user to view all their components present state, history and adjust settings. App.ionleaks.com even allows for a user to open/close their valve from any remote location!	
Remote Control	The Remote Control allows for an individual to locally control the state and mode of a group without the need of ionleaks.com	

Protect what matters most.

Gateway Specification Sheet

Gateway Overview:

The GT500 is the communication GATEWAY for the PipeBurst Pro system. It communicates with all wireless devices. The GT500 integrates with lonleaks.com, PipeBurst Pro's proprietary monitoring and control interface. The GT500 is available with cellular LTE connection as the GT500-LTE.

Gateway Specifications:

- Part #: GT500 / GT500-LTE
- Dimensions: 4" W x 3-3/4" H x 1" D
- Power Source: AC power adaptor
- Voltage: 12 VDC
- Housing: Aluminum
- Wireless Frequency: 915 MHz
- Cloud connection capability via ethernet or cellular (Verizon, AT&T, T-Mobile)

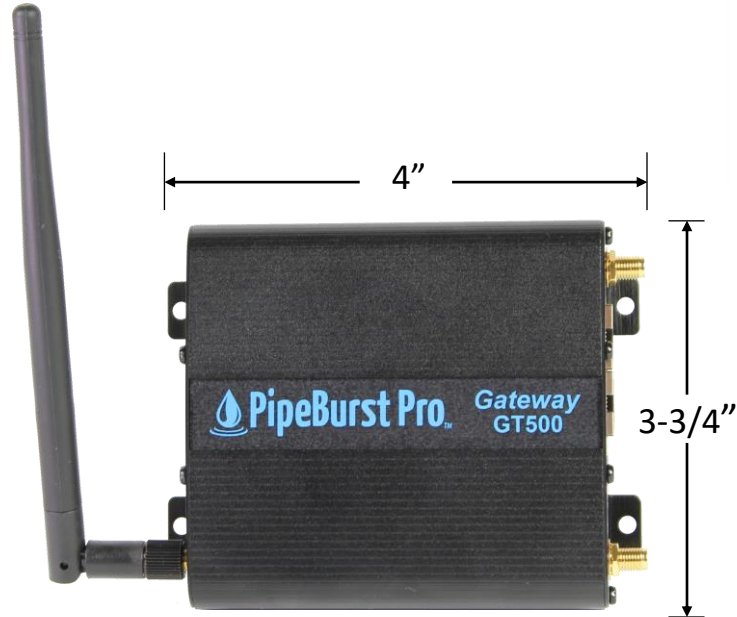

GT500
GT500-LTE

Gateway Features

- Sleek and compact design
- User-friendly wireless device registration
- Communicates with an infinite number of devices
- Multiple gateways can be used in conjunction to provide superior wireless coverage
- Different connection options allow for the GT500 to be connected via ethernet or cellular connection
- Cellular connection available with multiple major carriers
- Comprehensive system monitoring and control with lonleaks.com via any internet capable device. (GT500 includes an Ethernet port for standard connection)

Protect what matters most.

Relay and Switch Device Specification Sheet

Relay and Switch Overview:

The primary function of the RS Device is enabling wireless operation of equipment wired to it. The RS Device operates as a control module for the WaterValve and FloMeter and reports information to and from the GT500 gateway

Relay and Switch Specs:

- Part #: RS500
- Dimensions: 4-1/8" W x 4-3/4" H x 1-1/4" D
- LED Status display with relay toggle button
- Voltage: 5VDC
- Powered via AC Wall Adapter
- Internal Audible Alarm
- Tamper detection built in
- Wireless Frequency: 915MHz



RS500

Relay and Switch Features

- WaterValve control
- Read and report FloMeter usage
- Button to open/close valve on demand
- Built-in wire management compartment
- One RS500 can handle two devices (WaterValve/FloMeter)

Protect what matters most.

Remote Control Device Specification Sheet

Remote Control Overview:

The Remote Control provides convenient and seamless local control for a PipeBurst Pro 5 Group.

With multi-functional buttons. A user can utilize the remote to turn a group state on and off as well as toggle between home and away modes for FloMeter parameters

Remote Control Specifications:

- Part #: RC500
- Dimensions: 2" W x 3" H x 3/4" D
- Multi-Function Buttons
- Housing: ABS Plastic
- LED confirmation for State/Mode Changes
- Powered via CR2 battery
- Battery life of approximately 200,000 messages
- Wireless Frequency: 915MHz



RC500

Remote Control Features

- Multi-function buttons to turn water supply on and off for a specific group. Ability to change from home/away mode.
- LED confirmation of state/mode change
- Compact design allows RC500 to be stored anywhere.

Protect what matters most.

Water & Temperature Device Specification Sheet

Water & Temperature Device Overview:

Wireless Sensors are a frontline warrior in water detection, strategic placement provides maximum protection. Each sensor has a Unique Identification Number that is reported back to the Gateway when a sensor detects water.

If a leak occurs, Wireless Sensors detect the water and immediately send a signal to shut off the water, minimizing potential damage.

Water & Temperature Device Specifications:

- Part # WT500
- Dimensions: Ø 2-7/8" x 1-1/8" H
- Power Source: CR123A Battery
- Housing: ABS Plastic
- Gold Plated Water Sensor Pins
- Audible Notifications: Internal speaker
- Wireless Frequency: 915MHz
- Wired Water Sensor Terminals
- Unique Identification Number
- Temperature Sensor
- Tamper & Movement Detection

← Ø 2-7/8" →



WT500

Water & Temperature Device Features

- Wireless connectivity provides easy device installation.
- Easy wireless syncing with Gateway.
- Gold plated sensors provide increased detection sensitivity.
- Low power consumption affords 5+ years of battery life.
- Automatic power checks help you know when to change batteries.
- Tamper and movement detection alerts you if a device has been altered

Protect what matters most.

Wired Water Sensor Device Specification Sheet

Wired Water Sensor Device Overview:

Wired Water Sensors offer an additional point of protection to a WT500. With a compact design, the SK500 is perfect for detecting water in hard-to-reach areas.

If the Wired Water Sensor comes in contact with water, it will signal the Wireless Water Sensor to send a wet alert.

Wired Water Sensor Device Specifications:

- Part # SK500
- Dimensions: 1" x 3/4"
- Wire Length: 2m (6' 6")
- Gold Plated Water Sensing Pins
- Screw Hole Mount
- Adhesive Backing
- Connector: Two bare wire leads



Wired Water Sensor Device Features

- Compact design allows for sensor to fit almost anywhere
- Sensor head can be fixed in place with a screw or adhesive backing
- Two bare wires install easily into terminals on WT500 water sensor.

Protect what matters most.

WaterValve Specification Sheet

Valve Specs:

- ANSI/NSF 61 Certified, meets the Uniform Plumbing Code, Low-Lead certified, and approved for drinking water applications in all 50 states
- ¾" Valve body material is lead free brass
- 1" + Valve body: CF8M stainless steel
- Ball and Stem: 316 stainless steel
- Equipped with a manual handle for emergency override
- Valves are pressure rated at 70°F
- Full Port Valves for maximum flow
- Threads are FNPT

Actuator Specifications:

- Waterproof actuator housing is rated NEMA 6P to protect internal components from corrosion and extend actuator life
- Ignition safe actuator housing is rated NEMA 7D and meets the USCG Electrical Systems Standard to support user and environment protection
- 12V DC motor
- Actuator AC/DC adapter power supply and 6' wiring harness supplied with Part # RS500-11



Protect what matters most.

WaterValve Specification Sheet

Part Number	Size (Inch)	Cycle Time off	Pressure Rating	**Flow GPM	A	B	C	D
WVEZ3-T	3/4	0.8 sec.	600	36	6"	5.6"	7.6"	1.6"
WVFS3-T	1	0.8 sec.	600	68	5.0"	5.6"	7.8"	3.1"

**GPM at 1 PSI drop, water

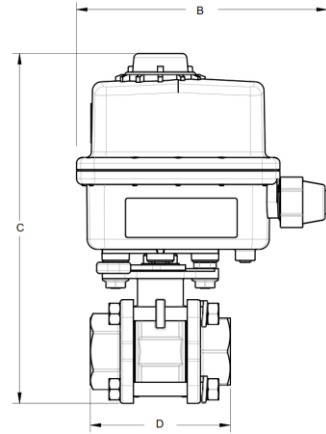
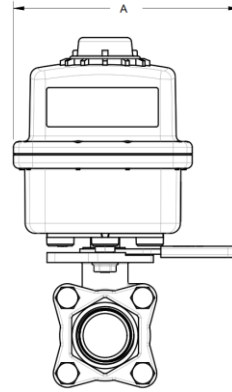

Part Number	Size (Inch)	Cycle Time off	Pressure Rating	**Flow GPM	A	B	C	D
WVGS2-T	1 ¼	3.0 sec.	1,000	112	11"	4.4"	9.1"	4.4"
WVHS2-T	1 ½	3.0 sec.	1,000	170	11.1"	4.4"	9.6"	4.8"
WVIS2-T	2	3.0 sec.	1,000	376	11.1"	4.4"	10.2"	5.4"

**GPM at 1 PSI drop, water

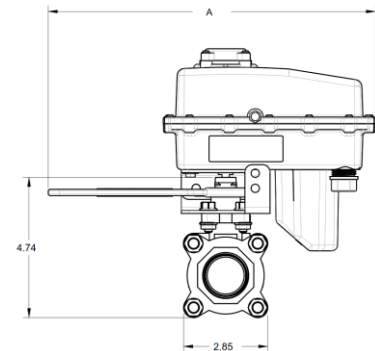
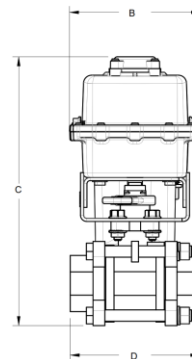

Part Number	Size (Inch)	Cycle Time off	Pressure Rating	**Flow GPM	A	B	C	D
WVKS5-T	3	3.0 sec.	1,000	1,300	11.3"	5.2"	13.4"	7.4"

**GPM at 1 PSI drop, water

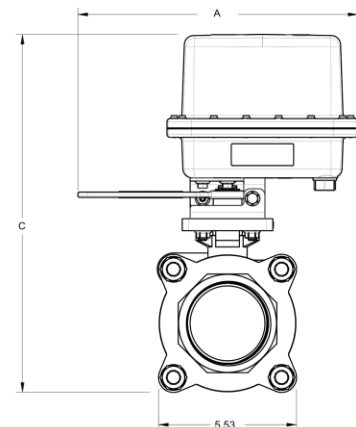
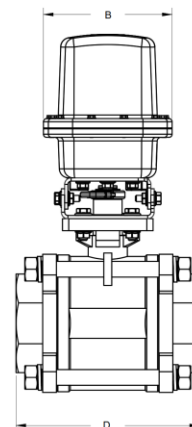

Protect what matters most.

FloMeter Specification Sheet

FloMeter Features:

- Meets AWWA C708 Accuracy
- Cold and Hot meter models available
- ¾" to 2" standard models, larger sizes are available on special order
- NSF61 and NSF372 approved
- Fully integrated with app.ionleaks.com
- Control maximum water usage for a specified period of time in minutes and/or hours
- Automatic water shut off or notification when maximum gallon parameters are exceeded



Technical Characteristics		
TEMPERATURE	Cold	105° F
	Hot	194° F
MAX PRESSURE	150psi	
MATERIALS	Body	ECO Brass No Lead
	Internals	Thermoplastic
PULSE OUTPUT	6ma @ 12vdc	
PULSE VALUE	1 Pulse / 1 Gallon	

Dimensions				
	¾"	1"	1 ½"	2"
LENGTH	7.5"	10.75"	12.625"	15.25"
HEIGHT	5.3"	5.3"	6.8"	6.8"
WIDTH	3.9"	3.9"	4.8"	4.8"
WEIGHT	4 LB	5 LB	10 LB	14 LB

Flow Rate					
MODEL	FM030	FM050	FM100	FM160	
GPM	¾"	1"	1 ½"	2"	% Error
MIN	0.5	0.75	1.5	2	3
MAX	30	50	100	160	1.5
CONTINUOUS	15	25	50	80	
RANGE	2-30	3-50	5-50	8-160	